

# TAP A NEW ENERGY CLASS



# EXCELSIOR SPIN

## Counters

The continuous search for technological innovation and new aesthetic lines has led Pastorfrigor to create the EXCELSIOR line. It is a new line of traditional remote service counters for the best display of fresh and pre-packed meat, with a large display volume and internal finishes in stainless steel. This is the SPIN model with spinning display area. The new design lines and elegant shapes catch the eye, both in the display area and externally on the peculiar sidewalls and the decoration.



# EXCELSIOR SPIN

## EXCELSIOR SPIN - Counters

### Power supply

Remote

### Climatic classes

3 M1

3 M2



### Available colours

1015

1021

2011

3002

3020

5005

5012

6018

7035

7037

9006

9010

9011

### Exhibition categories



Dairy, milk, cheese



Delicatessen



Fresh meat



Packed meat



Ready meals and  
salads



Sausages & salami

### Standard features

Expansion valve  
Fan assisted cooling  
Front anti-mist ventilation  
LED lighting  
Remote cabinet, with multiplexable linear modules  
Stainless Steel display decks  
Terminal board

### Accessories

Controller for electronic valve  
Automatic defrost  
CO2 refrigeration system  
Electronic control  
Front LED lighting  
Glycol refrigeration  
Stainless steel bumper  
With natural Gas R455

### Available dimensions

External depth (mm) 1474  
Base deck depth (mm) 1056  
Front Height (mm) 485  
Height (mm) 1153  
Length without side walls 1250 (mm)

# A SELECTION FROM OUR INSTALLATION

---



# CROSS SECTIONS

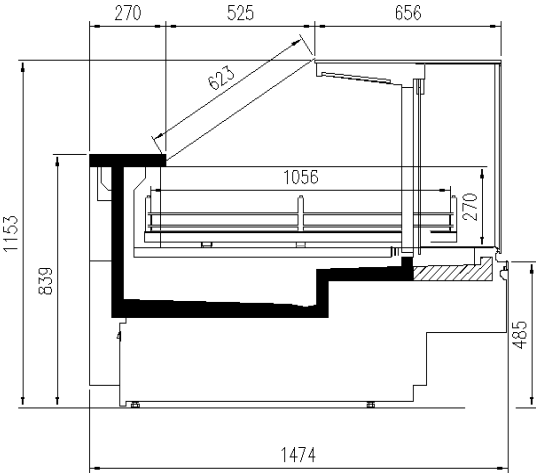

EXCELSIOR SPIN





**Pastorfrigor S.p.A.**

Reg. Gabannone, 4 Z.I. · 15033 Terruggia (AL) · Italy  
Tel. +39 0142 433 711 · Fax +39 0142 433 701 · [info@pastorfrigor.it](mailto:info@pastorfrigor.it)  
P.IVA IT00578270068 | REA AL-00578270068  
[www.pastorfrigor.it](http://www.pastorfrigor.it)